

**Application for a premises licence to be granted
under the Licensing Act 2003**

PLEASE READ THE FOLLOWING INSTRUCTIONS FIRST

Before completing this form please read the guidance notes at the end of the form. If you are completing this form by hand please write legibly in block capitals. In all cases ensure that your answers are inside the boxes and written in black ink. Use additional sheets if necessary.

You may wish to keep a copy of the completed form for your records.

I/We NORMAN ROAD STORES LTD
(Insert name(s) of applicant)

apply for a premises licence under section 17 of the Licensing Act 2003 for the premises described in Part 1 below (the premises) and I/we are making this application to you as the relevant licensing authority in accordance with section 12 of the Licensing Act 2003

Part 1 – Premises details

Postal address of premises or, if none, Ordnance Survey map reference or description			
20 NORMAN ROAD ST. LEONARDS ON SEA EAST SUSSEX			
Post town	ST. LEONARDS ON SEA	Postcode	TN37 6NH
Telephone number at premises (if any)	[REDACTED]		
Non-domestic rateable value of premises	£ 14,000 8,700		

Part 2 - Applicant details

Please state whether you are applying for a premises licence as Please tick as appropriate

- | | | |
|--|-------------------------------------|------------------------------|
| a) an individual or individuals * | <input type="checkbox"/> | please complete section (A) |
| b) a person other than an individual * | | |
| i as a limited company/limited liability partnership | <input checked="" type="checkbox"/> | please complete section 2(B) |
| ii as a partnership (other than limited liability) | <input type="checkbox"/> | please complete section (B) |
| iii as an unincorporated association or | <input type="checkbox"/> | please complete section (B) |
| iv other (for example a statutory corporation) | <input type="checkbox"/> | please complete section (B) |
| c) a recognised club | <input type="checkbox"/> | please complete section (B) |
| d) a charity | <input type="checkbox"/> | please complete section (B) |

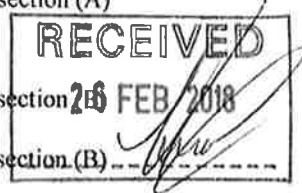

PREM 577
NOR SOS68
WM2017.11591. Page 17

Recd 26/02/2018
Ends 26/03/2018.

- e) the proprietor of an educational establishment please complete section (B)
- f) a health service body please complete section (B)
- g) a person who is registered under Part 2 of the Care Standards Act 2000 (c14) in respect of an independent hospital in Wales please complete section (B)
- ga) a person who is registered under Chapter 2 of Part 1 of the Health and Social Care Act 2008 (within the meaning of that Part) in an independent hospital in England please complete section (B)
- h) the chief officer of police of a police force in England and Wales please complete section (B)

* If you are applying as a person described in (a) or (b) please confirm (by ticking yes to one box below):

- I am carrying on or proposing to carry on a business which involves the use of the premises for licensable activities; or
- I am making the application pursuant to a statutory function or
- a function discharged by virtue of Her Majesty's prerogative

(A) INDIVIDUAL APPLICANTS (fill in as applicable)

<input type="checkbox"/> Mr	<input type="checkbox"/> Mrs	<input type="checkbox"/> Miss	<input type="checkbox"/> Ms	<input type="checkbox"/> Other Title (for example, Rev)	
Surname			First names		
Date of birth		I am 18 years old or over		<input type="checkbox"/>	Please tick yes
Nationality					
Current residential address if different from premises address					
Post town				Postcode	
Daytime contact telephone number					
E-mail address (optional)					

SECOND INDIVIDUAL APPLICANT (if applicable)

<input type="checkbox"/> Mr	<input type="checkbox"/> Mrs	<input type="checkbox"/> Miss	<input type="checkbox"/> Ms	<input type="checkbox"/> Other Title (for example, Rev)	
Surname			First names		

Date of birth		I am 18 years old or over <input type="checkbox"/> Please tick yes	
Nationality			
Current residential address if different from premises address			
Post town		Postcode	
Daytime contact telephone number			
E-mail address (optional)			

(B) OTHER APPLICANTS

Please provide name and registered address of applicant in full. Where appropriate please give any registered number. In the case of a partnership or other joint venture (other than a body corporate), please give the name and address of each party concerned.

Name	NORMAN ROAD STORES LTD
Address	THE OLD BANK HOUSE 1 THE HIGH STREET ARUNDEL WEST SUSSEX BN18 9AD
Registered number (where applicable)	10965207
Description of applicant (for example, partnership, company, unincorporated association etc.)	LIMITED COMPANY.
Telephone number (if any)	[REDACTED] / [REDACTED]
E-mail address (optional)	[REDACTED]

Part 3 Operating Schedule

When do you want the premises licence to start?

DD	MM	YYYY
03	03	0618

If you wish the licence to be valid only for a limited period, when do you want it to end?

DD	MM	YYYY

Please give a general description of the premises (please read guidance note 1)

CONVENIENCE STORE WITH PREVIOUS
ALCOHOL LICENCE (OFF LICENCE)
PLEASE SEE ATTACHED

Analysis A.
→

If 5,000 or more people are expected to attend the premises at any one time, please state the number expected to attend.

What licensable activities do you intend to carry on from the premises?

(please see sections 1 and 14 and Schedules 1 and 2 to the Licensing Act 2003)

Provision of regulated entertainment (please read guidance note 2)

Please tick all that apply

- a) plays (if ticking yes, fill in box A)
- b) films (if ticking yes, fill in box B)
- c) indoor sporting events (if ticking yes, fill in box C)
- d) boxing or wrestling entertainment (if ticking yes, fill in box D)
- e) live music (if ticking yes, fill in box E)
- f) recorded music (if ticking yes, fill in box F)
- g) performances of dance (if ticking yes, fill in box G)
- h) anything of a similar description to that falling within (e), (f) or (g) (if ticking yes, fill in box H)

Provision of late night refreshment (if ticking yes, fill in box I)

Supply of alcohol (if ticking yes, fill in box J)



In all cases complete boxes K, L and M

A

Plays Standard days and timings (please read guidance note 7)			Will the performance of a play take place indoors or outdoors or both – please tick (please read guidance note 3)	
			Indoors	<input type="checkbox"/>
			Outdoors	<input type="checkbox"/>
			Both	<input type="checkbox"/>
Day	Start	Finish	Please give further details here (please read guidance note 4)	
Mon				
Tue				
Wed			State any seasonal variations for performing plays (please read guidance note 5)	
Thur				
Fri				
Sat			Non standard timings. Where you intend to use the premises for the performance of plays at different times to those listed in the column on the left, please list (please read guidance note 6)	
Sun				

J

Supply of alcohol Standard days and timings (please read guidance note 7)			Will the supply of alcohol be for consumption – please tick (please read guidance note 8)	On the premises	<input type="checkbox"/>
				Off the premises	<input checked="" type="checkbox"/>
				Both	<input type="checkbox"/>
Day	Start	Finish	State any seasonal variations for the supply of alcohol (please read guidance note 5)		
Mon	9.00	10.00			
Tue	09.00	20.00			
Wed	09.00	20.00			
Thur	09.00	20.00			
Fri	09.00	20.00			
Sat	09.00	20.00			
Sun	09.00	20.00			
			Non standard timings. Where you intend to use the premises for the supply of alcohol at different times to those listed in the column on the left, please list (please read guidance note 6)		

State the name and details of the individual whom you wish to specify on the licence as designated premises supervisor (Please see declaration about the entitlement to work in the checklist at the end of the form):

Name	REV. MUTALIB ADELASME
Date of birth	[REDACTED]
Address	[REDACTED]
Postcode	[REDACTED]
Personal licence number (if known)	
Issuing licensing authority (if known)	

□□□□

K

Please highlight any adult entertainment or services, activities, other entertainment or matters ancillary to the use of the premises that may give rise to concern in respect of children (please read guidance note 9).

None

L

Hours premises are open to the public Standard days and timings (please read guidance note 7)			State any seasonal variations (please read guidance note 5)
Day	Start	Finish	<p style="text-align: center;">None</p>
Mon	0700		
		2300	
Tue	0700		
		2300	
Wed	0700		
		2300	
Thur	0700		
		2300	
Fri	0700	2300	
Sat	0700		
		2300	
Sun	0700	2-	
		2300	

Non standard timings. Where you intend the premises to be open to the public at different times from those listed in the column on the left, please list (please read guidance note 6)

None

Checklist:

Please tick to indicate agreement

- I have made or enclosed payment of the fee.
- I have enclosed the plan of the premises.
- I have sent copies of this application and the plan to responsible authorities and others where applicable.
- I have enclosed the consent form completed by the individual I wish to be designated premises supervisor, if applicable.
- I understand that I must now advertise my application. *Exempt.*
- I understand that if I do not comply with the above requirements my application will be rejected.
- [Applicable to all individual applicants, including those in a partnership which is not a limited liability partnership, but not companies or limited liability partnerships] I have included documents demonstrating my entitlement to work in the United Kingdom (please read note 15).

IT IS AN OFFENCE, UNDER SECTION 158 OF THE LICENSING ACT 2003, TO MAKE A FALSE STATEMENT IN OR IN CONNECTION WITH THIS APPLICATION. THOSE WHO MAKE A FALSE STATEMENT MAY BE LIABLE ON SUMMARY CONVICTION TO A FINE OF ANY AMOUNT.

IT IS AN OFFENCE UNDER SECTION 24B OF THE IMMIGRATION ACT 1971 FOR A PERSON TO WORK WHEN THEY KNOW, OR HAVE REASONABLE CAUSE TO BELIEVE, THAT THEY ARE DISQUALIFIED FROM DOING SO BY REASON OF THEIR IMMIGRATION STATUS. THOSE WHO EMPLOY AN ADULT WITHOUT LEAVE OR WHO IS SUBJECT TO CONDITIONS AS TO EMPLOYMENT WILL BE LIABLE TO A CIVIL PENALTY UNDER SECTION 15 OF THE IMMIGRATION, ASYLUM AND NATIONALITY ACT 2006 AND PURSUANT TO SECTION 21 OF THE SAME ACT, WILL BE COMMITTING AN OFFENCE WHERE THEY DO SO IN THE KNOWLEDGE, OR WITH REASONABLE CAUSE TO BELIEVE, THAT THE EMPLOYEE IS DISQUALIFIED.

Part 4 – Signatures (please read guidance note 11)

Signature of applicant or applicant’s solicitor or other duly authorised agent (see guidance note 12). **If signing on behalf of the applicant, please state in what capacity.**

M Describe the steps you intend to take to promote the four licensing objectives:

a) General – all four licensing objectives (b, c, d and e) (please read guidance note 10)

PLEASE SEE ATTACHED ANNEX B.

b) The prevention of crime and disorder

PLEASE SEE ATTACHED ANNEX B.

c) Public safety

PLEASE SEE ATTACHED ANNEX B.

d) The prevention of public nuisance

PLEASE SEE ATTACHED ANNEX B.

e) The protection of children from harm

Declaration	<ul style="list-style-type: none"> [Applicable to individual applicants only, including those in a partnership which is not a limited liability partnership] I understand I am not entitled to be issued with a licence if I do not have the entitlement to live and work in the UK (or if I am subject to a condition preventing me from doing work relating to the carrying on of a licensable activity) and that my licence will become invalid if I cease to be entitled to live and work in the UK (please read guidance note 15). The DPS named in this application form is entitled to work in the UK (and is not subject to conditions preventing him or her from doing work relating to a licensable activity) and I have seen a copy of his or her proof of entitlement to work, if appropriate (please see note 15)
Signature	
Date	
Capacity	

For joint applications, signature of 2nd applicant or 2nd applicant's solicitor or other authorised agent (please read guidance note 13). **If signing on behalf of the applicant, please state in what capacity.**

Signature	
Date	15/02/18
Capacity	DIRECTOR

Contact name (where not previously given) and postal address for correspondence associated with this application (please read guidance note 14)			
MUTALIB ADELASUYE 20 NORMAN ROAD ST. LEONARDS-ON-SEA			
Post town	ST. LEONARDS-ON-SEA	Postcode	TN37 6NH
Telephone number (if any)	[REDACTED]		
If you would prefer us to correspond with you by e-mail, your e-mail address (optional)			
[REDACTED]			

Notes for Guidance

- Describe the premises, for example the type of premises, its general situation and layout and any other information which could be relevant to the licensing objectives. Where your application includes off-supplies of alcohol and you intend to provide a place for consumption of these off-supplies, you must include a description of where the place will be and its proximity to the premises.
- In terms of specific regulated entertainments please note that:

- Plays: no licence is required for performances between 08:00 and 23:00 on any day, provided that the audience does not exceed 500.
- Films: no licence is required for 'not-for-profit' film exhibition held in community premises between 08:00 and 23:00 on any day provided that the audience does not exceed 500 and the organiser (a) gets consent to the screening from a person who is responsible for the premises; and (b) ensures that each such screening abides by age classification ratings.
- Indoor sporting events: no licence is required for performances between 08:00 and 23:00 on any day, provided that the audience does not exceed 1000.
- Boxing or Wrestling Entertainment: no licence is required for a contest, exhibition or display of Greco-Roman wrestling, or freestyle wrestling between 08:00 and 23:00 on any day, provided that the audience does not exceed 1000. Combined fighting sports – defined as a contest, exhibition or display which combines boxing or wrestling with one or more martial arts – are licensable as a boxing or wrestling entertainment rather than an indoor sporting event.
- Live music: no licence permission is required for:
 - a performance of unamplified live music between 08:00 and 23:00 on any day, on any premises.
 - a performance of amplified live music between 08:00 and 23:00 on any day on premises authorised to sell alcohol for consumption on those premises, provided that the audience does not exceed 500.
 - a performance of amplified live music between 08:00 and 23:00 on any day, in a workplace that is not licensed to sell alcohol on those premises, provided that the audience does not exceed 500.
 - a performance of amplified live music between 08:00 and 23:00 on any day, in a church hall, village hall, community hall, or other similar community premises, that is not licensed by a premises licence to sell alcohol, provided that (a) the audience does not exceed 500, and (b) the organiser gets consent for the performance from a person who is responsible for the premises.
 - a performance of amplified live music between 08:00 and 23:00 on any day, at the non-residential premises of (i) a local authority, or (ii) a school, or (iii) a hospital, provided that (a) the audience does not exceed 500, and (b) the organiser gets consent for the performance on the relevant premises from: (i) the local authority concerned, or (ii) the school or (iii) the health care provider for the hospital.
- Recorded Music: no licence permission is required for:
 - any playing of recorded music between 08:00 and 23:00 on any day on premises authorised to sell alcohol for consumption on those premises, provided that the audience does not exceed 500.
 - any playing of recorded music between 08:00 and 23:00 on any day, in a church hall, village hall, community hall, or other similar community premises, that is not licensed by a premises licence to sell alcohol, provided that (a) the audience does not exceed 500, and (b) the organiser gets consent for the performance from a person who is responsible for the premises.
 - any playing of recorded music between 08:00 and 23:00 on any day, at the non-residential premises of (i) a local authority, or (ii) a school, or (iii) a hospital, provided that (a) the audience does not exceed 500, and (b) the organiser gets consent for the performance on the relevant premises from: (i) the local authority concerned, or (ii) the school proprietor or (iii) the health care provider for the hospital.
- Dance: no licence is required for performances between 08:00 and 23:00 on any day, provided that the audience does not exceed 500. However, a performance which amounts to adult entertainment remains licensable.

- Cross activity exemptions: no licence is required between 08.00 and 23.00 on any day, with no limit on audience size for:
 - any entertainment taking place on the premises of the local authority where the entertainment is provided by or on behalf of the local authority;
 - any entertainment taking place on the hospital premises of the health care provider where the entertainment is provided by or on behalf of the health care provider;
 - any entertainment taking place on the premises of the school where the entertainment is provided by or on behalf of the school proprietor; and
 - any entertainment (excluding films and a boxing or wrestling entertainment) taking place at a travelling circus, provided that (a) it takes place within a moveable structure that accommodates the audience, and (b) that the travelling circus has not been located on the same site for more than 28 consecutive days.
- 3. Where taking place in a building or other structure please tick as appropriate (indoors may include a tent).
- 4. For example the type of activity to be authorised, if not already stated, and give relevant further details, for example (but not exclusively) whether or not music will be amplified or unamplified.
- 5. For example (but not exclusively), where the activity will occur on additional days during the summer months.
- 6. For example (but not exclusively), where you wish the activity to go on longer on a particular day e.g. Christmas Eve.
- 7. Please give timings in 24 hour clock (e.g. 16.00) and only give details for the days of the week when you intend the premises to be used for the activity.
- 8. If you wish people to be able to consume alcohol on the premises, please tick 'on the premises'. If you wish people to be able to purchase alcohol to consume away from the premises, please tick 'off the premises'. If you wish people to be able to do both, please tick 'both'.
- 9. Please give information about anything intended to occur at the premises or ancillary to the use of the premises which may give rise to concern in respect of children, regardless of whether you intend children to have access to the premises, for example (but not exclusively) nudity or semi-nudity, films for restricted age groups or the presence of gaming machines.
- 10. Please list here steps you will take to promote all four licensing objectives together.
- 11. The application form must be signed.
- 12. An applicant's agent (for example solicitor) may sign the form on their behalf provided that they have actual authority to do so.
- 13. Where there is more than one applicant, each of the applicants or their respective agent must sign the application form.
- 14. This is the address which we shall use to correspond with you about this application.

15. Entitlement to work/immigration status for individual applicants and applications from partnerships which are not limited liability partnerships:

A licence may not be held by an individual or an individual in a partnership who is resident in the UK who:

- does not have the right to live and work in the UK; or
- is subject to a condition preventing him or her from doing work relating to the carrying on of a licensable activity.

Any premises licence issued in respect of an application made on or after 6 April 2017 will become invalid if the holder ceases to be entitled to work in the UK.

Applicants must demonstrate that they have an entitlement to work in the UK and are not subject to a condition preventing them from doing work relating to the carrying on of a

licensable activity. They do this by providing with this application copies or scanned copies of the following documents (which do not need to be certified).

Documents which demonstrate entitlement to work in the UK

- An expired or current passport showing the holder, or a person named in the passport as the child of the holder, is a British citizen or a citizen of the UK and Colonies having the right of abode in the UK [please see note below about which sections of the passport to copy].
- An expired or current passport or national identity card showing the holder, or a person named in the passport as the child of the holder, is a national of a European Economic Area country or Switzerland.
- A Registration Certificate or document certifying permanent residence issued by the Home Office to a national of a European Economic Area country or Switzerland.
- A Permanent Residence Card issued by the Home Office to the family member of a national of a European Economic Area country or Switzerland.
- A **current** Biometric Immigration Document (Biometric Residence Permit) issued by the Home Office to the holder indicating that the person named is allowed to stay indefinitely in the UK, or has no time limit on their stay in the UK.
- A **current** passport endorsed to show that the holder is exempt from immigration control, is allowed to stay indefinitely in the UK, has the right of abode in the UK, or has no time limit on their stay in the UK.
- A **current** Immigration Status Document issued by the Home Office to the holder with an endorsement indicating that the named person is allowed to stay indefinitely in the UK or has no time limit on their stay in the UK, **when produced in combination with** an official document giving the person's permanent National Insurance number and their name issued by a Government agency or a previous employer.
- A **full** birth or adoption certificate issued in the UK which includes the name(s) of at least one of the holder's parents or adoptive parents, **when produced in combination with** an official document giving the person's permanent National Insurance number and their name issued by a Government agency or a previous employer.
- A birth or adoption certificate issued in the Channel Islands, the Isle of Man or Ireland **when produced in combination with** an official document giving the person's permanent National Insurance number and their name issued by a Government agency or a previous employer.
- A certificate of registration or naturalisation as a British citizen, **when produced in combination with** an official document giving the person's permanent National Insurance number and their name issued by a Government agency or a previous employer.
- A **current** passport endorsed to show that the holder is allowed to stay in the UK and is currently allowed to work and is not subject to a condition preventing the holder from doing work relating to the carrying on of a licensable activity.

- A **current** Biometric Immigration Document (Biometric Residence Permit) issued by the Home Office to the holder which indicates that the named person can currently stay in the UK and is allowed to work relation to the carrying on of a licensable activity.
- A **current** Residence Card issued by the Home Office to a person who is not a national of a European Economic Area state or Switzerland but who is a family member of such a national or who has derivative rights or residence.
- A **current** Immigration Status Document containing a photograph issued by the Home Office to the holder with an endorsement indicating that the named person may stay in the UK, and is allowed to work and is not subject to a condition preventing the holder from doing work relating to the carrying on of a licensable activity **when produced in combination with** an official document giving the person's permanent National Insurance number and their name issued by a Government agency or a previous employer.
- A Certificate of Application, **less than 6 months old**, issued by the Home Office under regulation 17(3) or 18A (2) of the Immigration (European Economic Area) Regulations 2006, to a person who is not a national of a European Economic Area state or Switzerland but who is a family member of such a national or who has derivative rights of residence.
- Reasonable evidence that the person has an outstanding application to vary their permission to be in the UK with the Home Office such as the Home Office acknowledgement letter or proof of postage evidence, or reasonable evidence that the person has an appeal or administrative review pending on an immigration decision, such as an appeal or administrative review reference number.
- Reasonable evidence that a person who is not a national of a European Economic Area state or Switzerland but who is a family member of such a national or who has derivative rights of residence in exercising treaty rights in the UK including:-
 - evidence of the applicant's own identity – such as a passport,
 - evidence of their relationship with the European Economic Area family member – e.g. a marriage certificate, civil partnership certificate or birth certificate, and
 - evidence that the European Economic Area national has a right of permanent residence in the UK or is one of the following if they have been in the UK for more than 3 months:
 - (i) working e.g. employment contract, wage slips, letter from the employer,
 - (ii) self-employed e.g. contracts, invoices, or audited accounts with a bank,
 - (iii) studying e.g. letter from the school, college or university and evidence of sufficient funds; or
 - (iv) self-sufficient e.g. bank statements.

Family members of European Economic Area nationals who are studying or financially independent must also provide evidence that the European Economic Area national and any family members hold comprehensive sickness insurance in the UK. This can include a private medical insurance policy, an EHIC card or an S1, S2 or S3 form.

Original documents must not be sent to licensing authorities. If the document copied is a passport, a copy of the following pages should be provided:-

- (i) any page containing the holder's personal details including nationality;

- (ii) any page containing the holder's photograph;
- (iii) any page containing the holder's signature;
- (iv) any page containing the date of expiry; and
- (v) any page containing information indicating the holder has permission to enter or remain in the UK and is permitted to work.

If the document is not a passport, a copy of the whole document should be provided.

Your right to work will be checked as part of your licensing application and this could involve us checking your immigration status with the Home Office. We may otherwise share information with the Home Office. Your licence application will not be determined until you have complied with this guidance.

Answer A

Description of the Premise

The premise is a lock-up shop on Norman Road St. Leonards on Sea East Sussex TN37 6NH. It has one-way traffic and short time parking with loading only facilities in the vicinity.

The shop is an off-licence and a convenience store (Shop local). The front of the shop is glass with a glass door and next to Adams and Jaret the Electronic store. The shop also host an ATM machine accessible to the public 24/7 from the shop front which is also fitted with Shutters for added security. The shop is fitted with both internal and external CCTV Cameras with DVR operating 24/7 and recordings are kept for 31 days.

The shop has a back office with WC and wash hand basin. There is no access to the shop from the back of the building.

The application is for off-licence, if granted the company will be selling alcohol and associated goods although the focus of the business is to be a food supermarket of many nations and as a local convenience store.

We are applying for a Licence to operate between 0700hrs to 2300hrs Sunday to Saturday. Sales will be off-sales only. The shop is well lit inside and outside and there are no Health and Safety issues. The shop has fire extinguishers fitted with annual checks and the on-going business was approved with a level 4 annual Hygiene Certificate by the Council Authorities.

TO PROMOTE ALL FOUR LICENSING OBJECTIVES WE WILL KEEP:

Strong management controls and effective training of all staff so that they are aware of the premises licence and the requirements to meet the four licensing objectives with particular attention to:

- a) No selling of alcohol to underage people
- b) No drunk and disorderly behaviour on the premises area
- c) Vigilance in preventing the use and sale of illegal drugs at the retail area
- d) No violent and anti-social behaviour
- e) No any harm to children

Operating Schedule providing the hours of operation and licensable activities during those hours

Designated premises supervisor confirmed it is obligated to be in day-to-day control of the premises, to provide good training for staff on the Licensing Act (Training Record), to make or authorize each sale

Clear "Challenge 25" information to prevent the supply of alcohol to under-age drinkers.

CCTV system installed with recording option available

Roller metal exterior window shutter is fixed to ensure that shop front is safe and secure at all times

As a licensed premise we know that it is necessary to carry out our functions or operate our businesses with a purpose of promoting these objectives. We promise to support these objectives through our operating schedules and other measures (including staff training and qualifications, policies, and strategic partnerships with other agencies).

1. The prevention of crime and disorder

CCTV System is installed to monitor entrances, exits, and other parts of the premises in order to address the prevention of crime objective.

A clear and legible notice outside the premises indicating the normal hours under the terms of the premises licence during which licensable activities are permitted

Clear and conspicuous notices warning of potential criminal activity, such as theft, that may target customers will be displayed.

Not selling of alcohol to drunk or intoxicated customers.

Custom will not be sought by means of personal solicitation outside or in the vicinity of the premises.

Prevention and vigilance in illegal drug use at the retail unit area

Staff will be well trained in asking customers to use premises in an orderly and respectful manner and prevent drinking alcohol at the retail unit (ex. canned or bottled beer).

2. Public safety

Internal and external lighting fixed to promote the public safety objective.

Well trained staff adherence to environmental health requirements.

Training and implementation of underage ID checks

A log book or recording system shall be kept upon the premises in which shall be entered particulars of inspections made; those required to be made by statute, and information compiled to comply with any public safety condition attached to the premises licence that requires the recording of such information. The log book shall be kept available for inspection when required by persons authorised by the Licensing Act 2003 or associated legislation.

All parts of the premises and all fittings and apparatus therein, door fastenings and notices, lighting, heating, electrical, air condition, sanitary accommodation and other installations, will be maintained at all times in good order and in a safe condition.

3. The prevention of public nuisance

Noise reduction measures to address the public nuisance objective.

Prominent, clear and legible notices will be displayed at the exit requesting the public to respect the needs of nearby residents and to leave the premises and the area quietly.

Deliveries of goods necessary for the operation of the business will be carried out at such a time or in such a manner as to prevent nuisance and disturbance to nearby residents.

The Licensee will ensure that staffs who arrive early morning or depart late at night (ex. for unpacking, pricing newly delivered goods) when the business has ceased trading conduct themselves in such a manner to avoid causing disturbance to nearby residents.

Customers will be asked not to stand around loudly talking in the street outside the premises.

Customers will not be admitted to premises above opening hours.

The movement of bins and rubbish outside the premises will be kept to a minimum after 11.00pm. This will help to reduce the levels of noise produced by the premises.

Any lighting on or outside the premises will be positioned and screened in such a way so as to not cause a disturbance to nearby residents.

Adequate waste receptacles for use by customers will be provided in the local vicinity.

4. The protection of children from harm

"Challenge 25" sign which is a retailing strategy that encourages anyone who is over 18 but looks under 25 to carry acceptable ID (a card bearing the PASS hologram, a photographic driving license or a passport) if they wish to buy alcohol.

Well trained staff about requirement for persons' identification, age establishment etc.

All the details provided in Training Record Book available at the retail unit.

Log Book will be kept upon the premises all the time.

Nothing that contradicts existing Health & Safety requirements.

Consent of individual to being specified as premises supervisor

REV. MUTALIB KAYODE-A. ADELASOYE

I NORMAN ROAD STORES LTD

[full name of prospective premises supervisor]

of



[home address of prospective premises supervisor]

hereby confirm that I give my consent to be specified as the designated premises supervisor in relation to the application for

ALCOHOL LICENCE

[type of application]

by

NORMAN ROAD STORES LTD

[name of applicant]

relating to a premises licence

[number of existing licence, if any]

for

20 NORMAN ROAD ST. LEONARD-ON-SEA TN37 6NH

[name and address of premises to which the application relates]

and any premises licence to be granted or varied in respect of this application made by

NORMAN ROAD STORES LTD

[name of applicant]

concerning the supply of alcohol at



20 NORMAN ROAD ST. LEONARDS-ON-SEA TN37 6NH

[name and address of premises to which application relates]

I also confirm that I am entitled to work in the United Kingdom and am applying for, intend to apply for or currently hold a personal licence, details of which I set out below.

Personal licence number

[insert personal licence number, if any]

Personal licence issuing authority

[insert name and address and telephone number of personal licence issuing authority, if any]

Signed

Name (please print)

KEV MUTALIB d. A. ADEWASOYE

Date

08/02/18

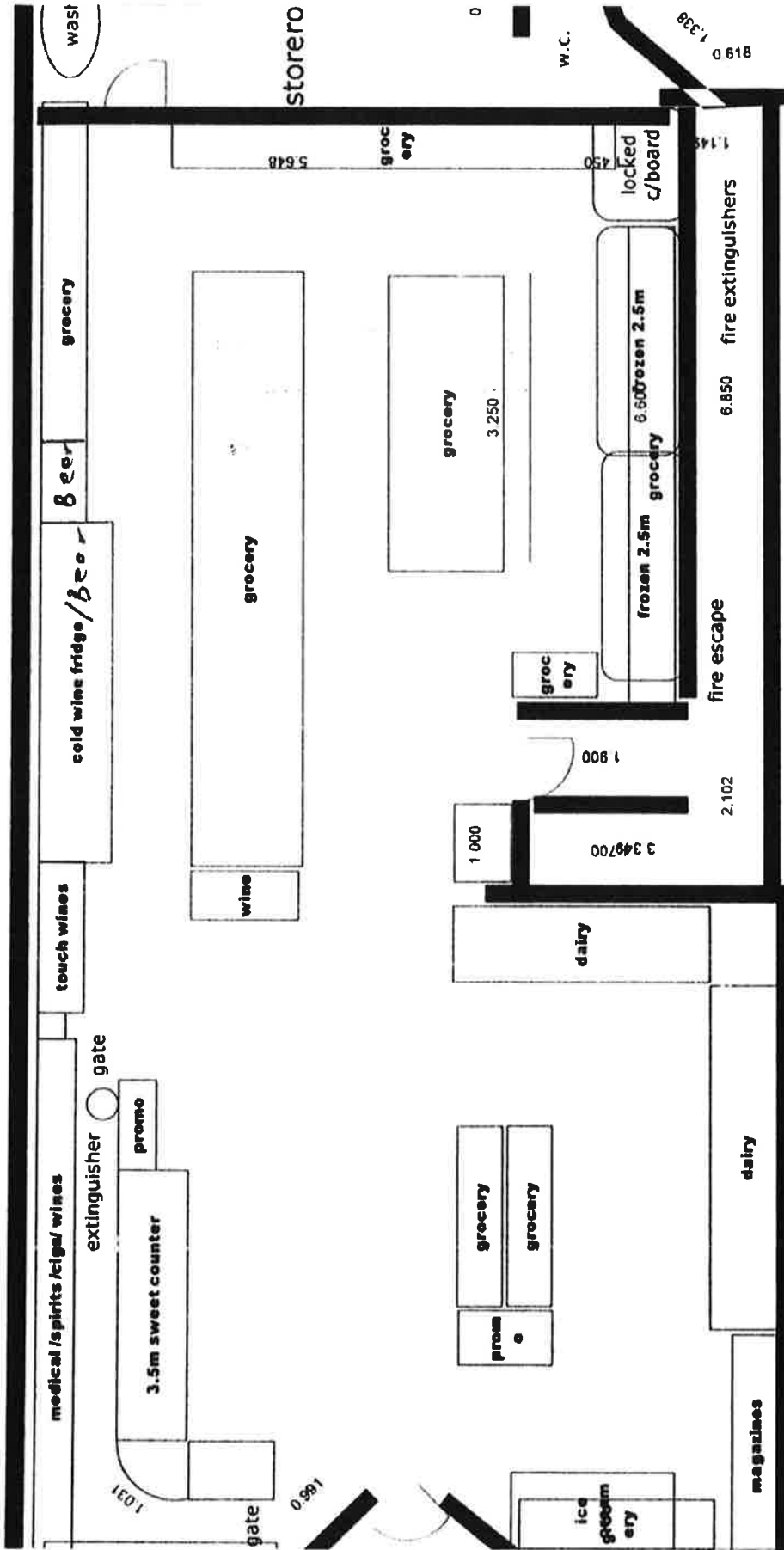

RECEIVED
26 FEB 2018

LAYOUT OF
MARKET
SHOP FLOOR PLAN 1 : 100
20 NORMAN ROAD
ST LEONARDS ON SEA
TN37 6NH

